



Venture Lighting LED Batten

Installation Instructions and Conditions of Use

IMPORTANT INFORMATION

- Please understand the following instructions and installation procedure before proceeding. Work should be carried out by a qualified electrician.
- The standard warranty offered with these LED products as displayed at www.venturelightingeurope.com/technical-centre/warranty can only be upheld providing the following instructions and conditions of use are strictly adhered to. Venture Lighting will not be held responsible for any claims resulting from inadequate installation and therefore advice may be required from a qualified person before proceeding.
- This product cannot be serviced; there are no serviceable parts inside and the product should not be opened unless instructed below to enable electrical connection / or mechanical fixing.
- The LEDs in the luminaire are not replaceable and the casing should not be opened. When the LEDs reach end of life the whole luminaire shall be replaced.
- For emergency versions, connect battery before first use.

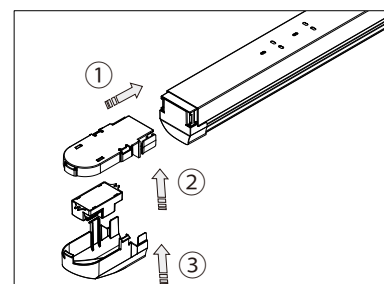
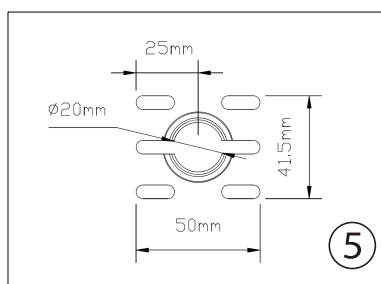
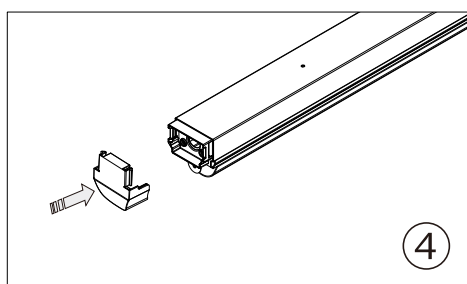
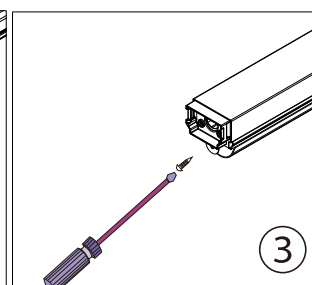
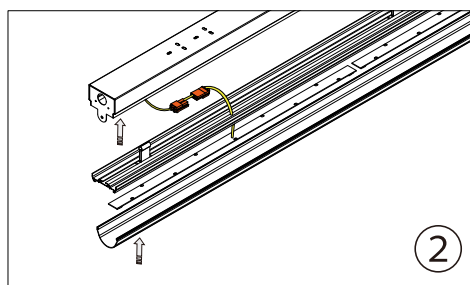
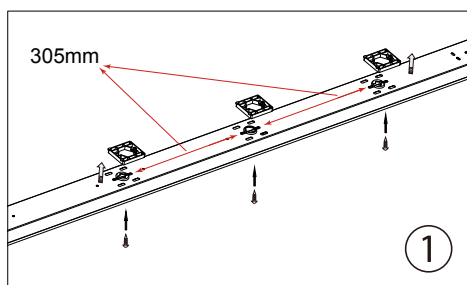
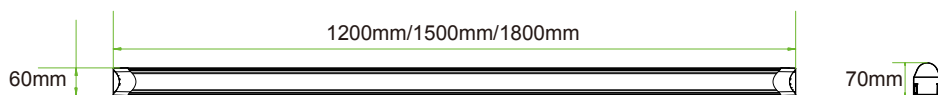

Wiring Instructions

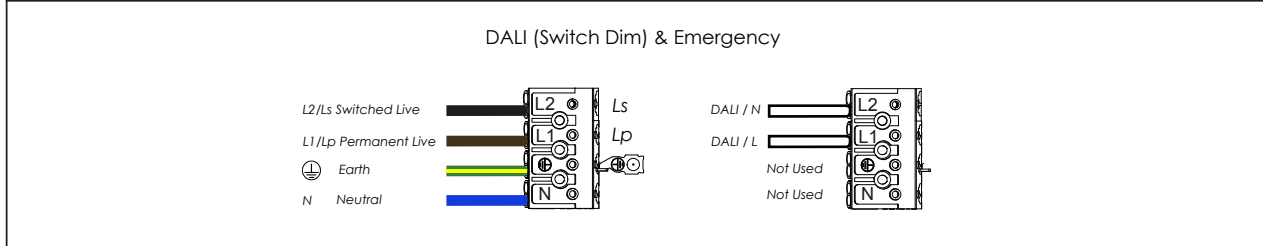
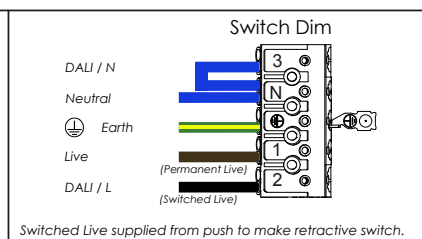
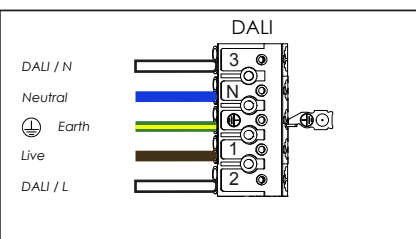
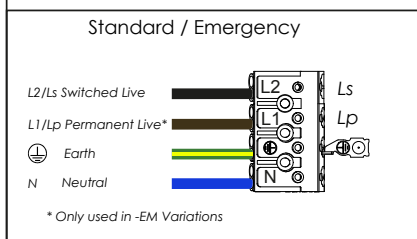

For Switch Dim wiring, connect a permanent live to L1 and wire supply from retractive switch (push to make) to DALI / L. Also link between N and DALI / N.

