

ACS382 REMOTE CONTROL



BS EN 60598-1 / BS EN 60598-2-22 / BS EN 50172 / BS EN 1838 / BS EN 62034 / ISO 7010 / ISO 3864

Thank you for purchasing our ACS382 Remote Control. Our products have been designed according to the relevant standards and if installed and maintained correctly will provide a long service life.

This product should only be used by suitably qualified personnel.

This product can be used to send commands to compatible Venture Lighting self-test emergency luminaires and conversion kits.*

Please see below which functions are available for each version.

It requires two AAA batteries.

*ACS382 remote control adds new features to self-test emergency luminaires and it is an optional tool for those responsible for emergency lighting installations. Note that self-test emergency luminaires work independently from the remote control. ACS382 can also be used to initiate a duration test on manual test luminaires - please contact us for information.

Part no.	Description	Operating Temperature	Net Weight
ACS382	Remote Control	0 - 40°C	0.06 kg

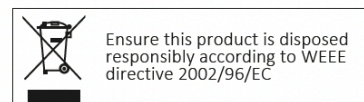
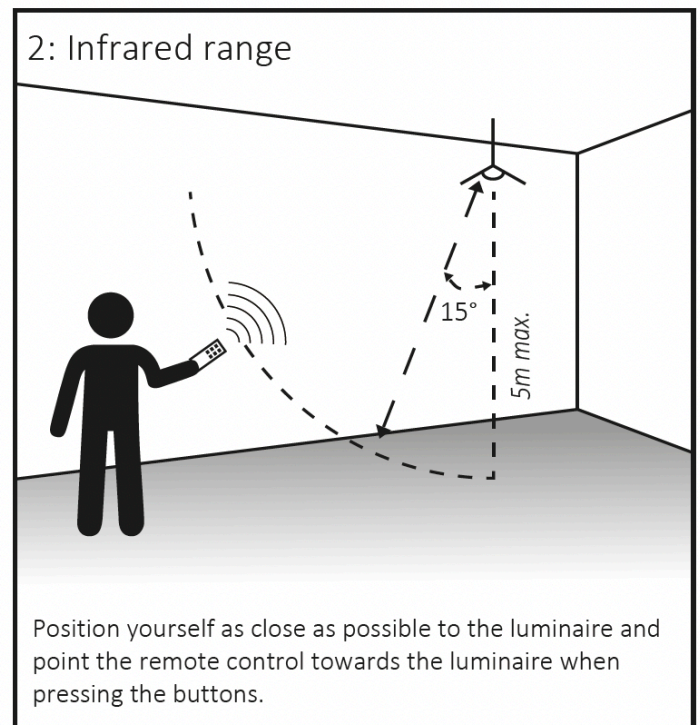
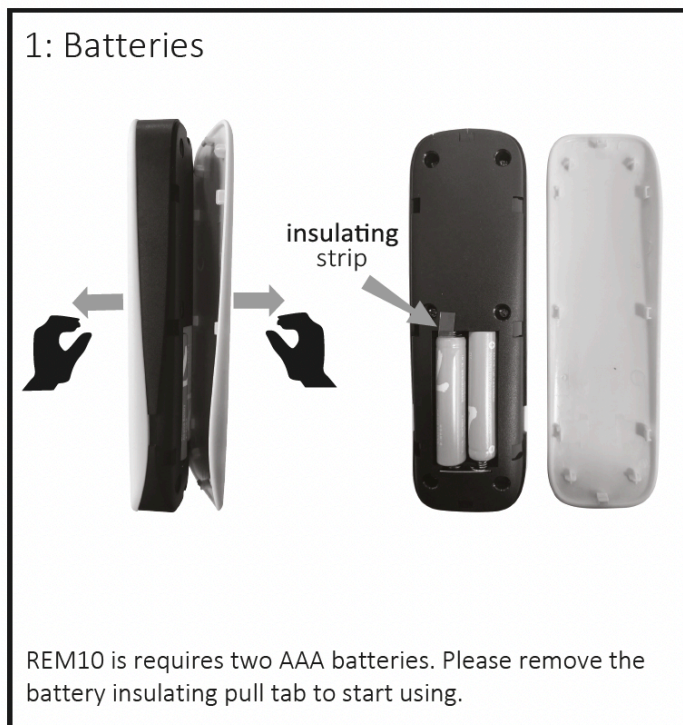

ACS382 REMOTE CONTROL



BS EN 60598-1 / BS EN 60598-2-22 / BS EN 50172 / BS EN 1838 / BS EN 62034 / ISO 7010 / ISO 3864

FUNCTIONS

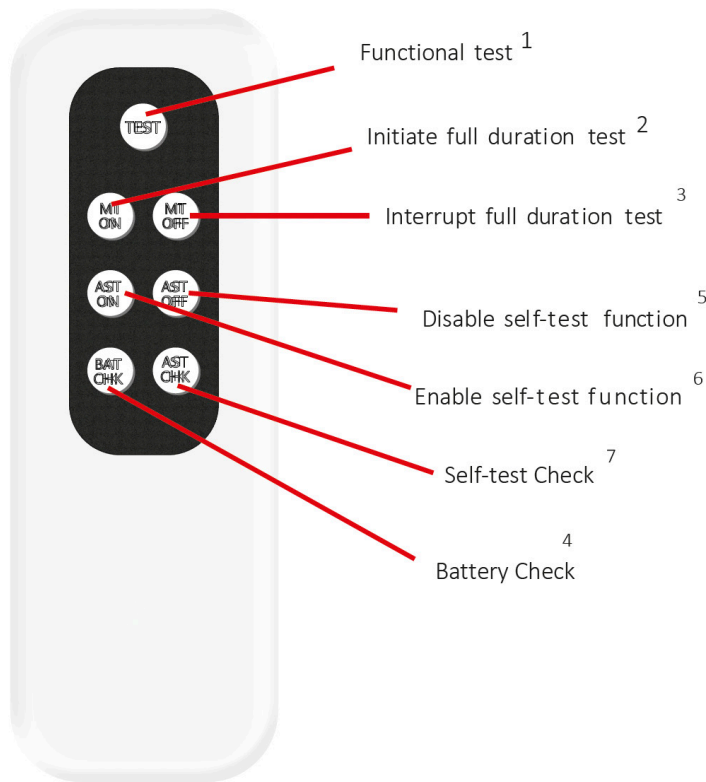

FUNCTIONS FOR SELF TEST VERSIONS:

1. Press "TEST" to carry out a Functional Test
2. Press "MT ON" to initiate a Full Duration Test*
3. Press "MT OFF" to interrupt Full Duration Test
4. Press "BAT CHK" to check status of battery's health.**
5. Press "AST OFF" to disable self-test function
6. Press "AST ON" to enable self-test function
7. Press "AST CHK" to verify status of self-test function

After each button press the indicator will flash GREEN/RED to acknowledge the command.



* Note that when the Full Duration Test is completed the batteries require up to 8 hours to be re-charged again.

** Note that battery status is recorded and updated after full duration test is completed.

FLASHING CODES FOR SELF-TEST CHECK (FUNCTION 7)

Self-Test status check:

	FLASHING CODE	SELF-TEST STATUS
Red / Green LED Indicator	1x Green / Red 	Self-Test Enabled
	2x Green / Red 	Self-Test Disabled

- OFF
- ON
- Slow flash 0.5Hz
- Normal flash 1Hz (once/second)
- Fast flash 2Hz (twice/second)

FLASHING CODE FOR BATTERY HEALTH CHECK (FUNCTION 4)

Battery Health/Status Check

	FLASHING SEQUENCE	BATTERY STATUS (EMERGENCY LIGHTING DURATION)	APPROX. CAPACITY RESERVE
Green / Red LED Indicator	4x Green / Red 	Battery not yet tested (status will be available after first full duration test)	
	1x Green / Red 	Duration > 3hr 30min	Excess Capacity > 16%
	2x Green / Red 	3hr 15min < Duration < 3hr 30min	Excess Capacity < 16% > 8%
	3x Green / Red 	3hr < EM duration < 3hr 15min	Excess Capacity < 8% > 0%

ACS382 REMOTE CONTROL



BS EN 60598-1 / BS EN 60598-2-22 / BS EN 50172 / BS EN 1838 / BS EN 62034 / ISO 7010 / ISO 3864

FLASHING CODE FOR FAULT CONDITION (FUNCTION 1)

Status Indication

Green / Red LED Indicator	Green LED	Red LED	Status
	●	●	Status OK - Battery Charged
	◉	○	Battery Charging
	○	●	Battery Disconnected/ Duration Test Fail
	◉	○	Test in Progress
	○	◉	Battery Outside Temperature Range
	○	◉	Load/Light Source Fault